



# ENTRY FORM / APPLICATION

Deadline: September 13<sup>th</sup> , 2011

<b>OFFICIAL USE</b>	Date Rcvd.
App.#	Car#

**DRIVER:** First Name: \_\_\_\_\_ Last Name: \_\_\_\_\_

Address: \_\_\_\_\_ City: \_\_\_\_\_ State: \_\_\_\_\_ Zip Code: \_\_\_\_\_

Tel.: Res. (    ) \_\_\_\_\_ Mobile (    ) \_\_\_\_\_ E-mail \_\_\_\_\_

Dr.Lic.# \_\_\_\_\_ Exp. Date: \_\_\_\_\_ Date of Birth: \_\_\_\_\_

**NAVIGATOR:** First Name: \_\_\_\_\_ Last Name: \_\_\_\_\_

Address: \_\_\_\_\_ City: \_\_\_\_\_ State: \_\_\_\_\_ Zip Code: \_\_\_\_\_

Tel.: Res. (    ) \_\_\_\_\_ Mobile (    ) \_\_\_\_\_ E-mail \_\_\_\_\_

Dr.Lic.# \_\_\_\_\_ Exp. Date: \_\_\_\_\_ Date of Birth: \_\_\_\_\_

**PASSENGER 1:** First Name: \_\_\_\_\_ Last Name: \_\_\_\_\_

**PASSENGER 2:** First Name: \_\_\_\_\_ Last Name: \_\_\_\_\_

The undersigned wishes to enter and participate in the Navigational Rally organized and conducted by Homenetmen Glendale Ararat Chapter October 15<sup>th</sup>, 2011. The undersigned hereby:

- 1) Releases Homenetmen Glendale Ararat Chapter, it's directors, all the volunteers and agents and Rally organizers from any and all liabilities which may arise out of such event.
- 2) Declares that they have personally received and read the Rules and Regulations under which the Rally event will be conducted and agree to abide by said rules and regulations.

**DRIVER SIGNATURE:** \_\_\_\_\_ **DATE:** \_\_\_\_\_

**NAVIGATOR SIGNATURE:** \_\_\_\_\_ **DATE:** \_\_\_\_\_

**PASSENGER 1 SIGNATURE:** \_\_\_\_\_ **DATE:** \_\_\_\_\_

**PASSENGER 2 SIGNATURE:** \_\_\_\_\_ **DATE:** \_\_\_\_\_

Palm Springs



# FEE SCHEDULE 2011

Mail completed forms to:  
Andre Guilanians  
3041 Hopeton Rd  
LaCrescenta, CA 91214

**Must complete -- Do it!**

Fee Schedule	Each Person	Number of People	TOTAL
Rally Participation Fee	\$160.00		\$
After Rally Reception for non participants	\$25.00		\$
Breakfast for non participants	\$20.00		\$

	Each Room	Number of Rooms	TOTAL
Hotel Room (Double Occupancy)	\$145.00		\$
Each Additional person (Total of 4 people allowed in each room)	\$20.00		\$

**Grand Total** \$

**Fun you will have - Priceless For Everything else, you can pay by check or credit card!!**

**PLEASE COMPLETE THIS SECTION IF PAYING BY CHECK**

**NO REFUNDS**

Check # \_\_\_\_\_ Please Make Checks Payable To: **Homenetmen Ararat Chapter**

**PLEASE COMPLETE THIS SECTION IF PAYING BY CREDIT CARD**

CREDIT CARD: VISA  MASTER CARD  AMX

ENTER CREDIT CARD NUMBER: \_\_\_\_\_ CARD EXPIRES ON 

--	--	--	--

CARD HOLDER NAME (Please PRINT): \_\_\_\_\_ BILLING ZIP CODE: \_\_\_\_\_

CARD HOLDER SIGNATURE: \_\_\_\_\_

Palm Springs



## SCHEDULE OF EVENTS

PLEASE COMPLETE  
AND RETURN THE  
APPLICATION & FEES  
BEFORE  
September 13<sup>th</sup>, 2011

## VERY IMPORTANT DATES

 Tue Sept.13, 2011

**DEADLINE FOR APPLICATIONS**

On site registration at 7:30 PM at Ararat

T.B.D. (7:30 PM at Ararat Center) ORIENTATION FOR NOVICES ONLY

Wed. Oct. 12, 2011 (7:00 PM at Ararat Center) CAR NUMBER ASSIGNMENT

Driver & Navigator **Must** Be Present With Their completed & signed Car Inspection Form and Proof Of Insurance

Wed. Oct. 12, 2011 (8:00 PM at Ararat Center): FINAL ORIENTATION

 Sat. Oct. 15, 2011 6:31 AM

**START FROM ARARAT PARKING**

LOT

Car # 1 Receives Route Inst. at 6:26 AM  
Car # 1 Departs at 6:31 AM  
Remaining Cars Depart at 1 Min. Intervals.

 Sun. Oct. 16, 2011, 10:00 AM:

**Brunch and Results**

At the Destination Hotel

Mail your completed applications along with the fees to:  
**Andre Guilanians** – 3041 Hopeton Rd, LaCrescenta, CA 91214

For more Information, please call:  
Eve. (818) 248-6643.....Cell. (818) 642-6643



# CAR INFORMATION AND INSPECTION

Car No. \_\_\_\_\_

**Driver / Navigator** \_\_\_\_\_  
Print Full Name

**CAR INFO.:** Make: \_\_\_\_\_ Model: \_\_\_\_\_  
 Color: \_\_\_\_\_  
 Registered Owner: \_\_\_\_\_ Lic. Plate #: \_\_\_\_\_  
 Insurance Co.: \_\_\_\_\_ Policy #: \_\_\_\_\_  
 Exp. Date: \_\_\_\_\_

	DESCRIPTION	POOR	FAIR	GOOD
1	Sharp edge protection			
2	Head lights			
3	Direction lights			
4	Hazard			
5	Stop lights			
6	Horn			
7	Wiper blade			
8	Tires Condition			
9	Brake pedal travel			
10	Seat belt			
11	Battery leads			
12	Spare tire/Jack etc...			

<b>Navigational System</b> factory installed or after market	<b>YES</b> __	<b>NO</b> __
--	---------------	--------------

I, \_\_\_\_\_ Registered owner or  
Last Name, Middle Initial, First Name

renter of above referenced vehicle, certify that the above inspection has been completed and my vehicle is road worthy to participate in the Ararat Rally.

\_\_\_\_\_  
 Registered Owner's Signature



# RULES AND REGULATIONS

## 24<sup>th</sup> ANNUAL ARARAT RALLY

### 10/15/2011

#### GENERAL RULES & INFORMATION

- 1) This is a Navigational (Time / Speed / Distance) Rally. It is planned for the participants' enjoyment and will be conducted in accordance with the following rules and regulations.
- 2) **A Navigational Car Rally is Not a Race.** The State of California Traffic Laws and Codes must be obeyed at all times. Seat belts must be fastened at all times, when vehicle is in motion. Current Cell Phone laws must be observed.
- 3) The object of the competition is to follow the prescribed course and to arrive at each MANNED and DIYC Time Control when one is due, neither early nor late.
- 4) Participants may not drink nor be under the influence of alcoholic beverages or drugs. Participants may not drive **recklessly or illegally during the event**. Doing so will result in immediate disqualification of the participant and the team.
- 5) Traffic signals and stop signs may not indicated on the road maps. Participants should adhere to traffic laws at all times.
- 6) The use of 2-way radios, CB's, cellular phones or **satellite navigational systems** is forbidden during the rally, except in emergencies. Violators may be disqualified from the race.
- 7) Eligible Rally roads are public streets, roads, freeways, highways, even if marked by "Road Ends ... Feet" signs. Streets marked as "Dead End", "Not a Through Street", "Not a Through Road", "No Outlet", "Area Closed – No Trespassing", cul-de-sacs, Park Entrances and unpaved roads are not an opportunity and should not be entered unless specifically asked to do so. However, they count as streets or landmarks. Do not enter private driveways, alleys, businesses, shopping or government centers. **Unpaved roads may be used during the Rally and should be used only when instructed.**

- 8) Each Route instruction and landmark must be completed at the first possible point satisfying the instruction and instruction notes, and consistent with the General Rules and Regulations and its amendment(s).  
Execute each part of a multiple step route instruction in the order presented.
- 9) Quotation marks if used in the route instructions will indicate the complete or partial text and / or Street name and / or illustration(s) of the sign to be used.
- 10) A Landmark is an object that is located on the right, or overhead in the direction of travel, (on the right). This rule does not apply to “Stay On” instructions. Landmarks in the road book can be provided by an illustration, clip art or text. All text will be in quotation marks.

## **DEFINITIONS AND ABBREVIATIONS**

- 1) **CAST**                      Change average speed to
- 2) **FREE ZONE**              A specified portion of the rally in which there are no manned checkpoints.
- 3) **L or LEFT**                Turn left at an intersection from 10 to 179 degrees.
- 4) **OPP**                        Opportunity, AN INTERSECTION where, independent of the distance from previous stage you can perform the road book Instruction.
- 5) **PAUSE**                    Delay the specified time. Each pause is executed at the reference point.
- 6) **R or RIGHT**              Turn right at an intersection from 10 to 179 degrees.
- 7) **STOP**                      A conventional stop sign that requires you to STOP.
- 8) **SIGNAL**                    An intersection at which your progress is controlled by a Conventional red, amber, and green traffic signal, working or not working.
- 9) **T**                            An intersection with the general shape of the letter T as you approach it from the base, where you can turn right or left.
- 10) **S.O.L.**                    Sign on left. All landmarks and quoted sign(s) are on the right, or overhead in the direction of travel (on the right) unless specified in the road instruction to be on the left. This does not apply to “Stay On” instructions.
- 11) **“M.P.H”**                 Miles Per Hour. “50 MPH”
- 12) **“Max Sp.”**                Maximum Speed
- 13) **!**                            CAUTION
- 14) **————**                 Paved Road, Freeway, Freeway on-ramps or off-ramps
- 15) **- - - -**                    Unpaved Road

- 16) **@ = at**                    In the vicinity of for course instruction; even with for other instructions, including CAST, pauses, mileages, etc.
- 17) **ST.**                        Street
- 18) **STRAIGHT**                Continue in the most straightforward direction through an intersection.
- 19) **TURN**                      Turn either Right or Left, but only in one direction possible.
- 20) **W.O.F.**                    Whichever occurs first.
- 21) **S.A.**                        Sign anywhere.
- 21) **ROUTE RULES**          Categorized by letters A, B, C.... are part of the general instructions, and must be executed in accordance with all rally rules, when instructed.

## **TIME CONTROLS (TC), or CHECKPOINTS**

### **A. Manned Time Controls (TC), or Checkpoints**

Participants will be Timed In as the front wheels of their car passes The In Marker (A Cone). Participants should not stop at the In Marker but continue to Time Control officials to receive their **IN** and **OUT TIME** recorded on the time card by the official stationed at the control. Your Out Time will be the same as your In Time unless, otherwise instructed by a Time Controller.

- 1) It is the participants' responsibility to ensure that times are recorded correctly on the time card.
- 2) The in times and out times will be recorded in hour and minutes only (i.e. 12hrs 15 minutes and 55 seconds will be recorded as 12 hrs and 15 minutes).
- 3) No stopping before the In Marker is allowed. Stopping early will obstruct other participants right of way as well as the traffic. In such a case the Time Controller will log the time as soon as he/she has had eye contact with the subject car.

### **B. DIYC (Do It Yourself Checkpoint)**

- 1) At a DIYC, write your IN TIME or arrival time (in hours and minutes) in the assigned box on your Time Card.
- 2) Your OUT TIME is the same as your IN TIME.

- 3) You must write your In and Out Time on your control card at the exact prescribed location, or you will be scored as having missed the DIYC. You may not change Your DIYC time after entering any manned checkpoint.

### C. General

- 1) It is forbidden to enter a Time Control Area in any direction other than that of the Rally Route.
- 2) It is forbidden to re-cross, or back-up into a Time Control Area.
- 3) If several cars arrive at the same Time Control Area, all should stop at an orderly manner, and should approach the official with their Time Card in order to record their time.
- 4) Time Controls will open 15 minutes before the scheduled arrival Time of the first participant, and close 30 minutes after the scheduled arrival Time of the last participant.
- 5) Any items on the Time Card that has been altered or appears to have been tampered with may be deemed void and will not be considered for final calculations.

## ODOMETER CALIBRATION

**Calibrate your car's odometer in the following way:**

- 1) Place your car's front tires on the first line of the cross walk at the intersection on Alameda and Glenoaks, in Burbank.
- 2) Drive to the first line of the crosswalk at the intersection of Brand and Glenoaks in Glendale. The distance between the two intersections' cross walks should read 2.80 miles.

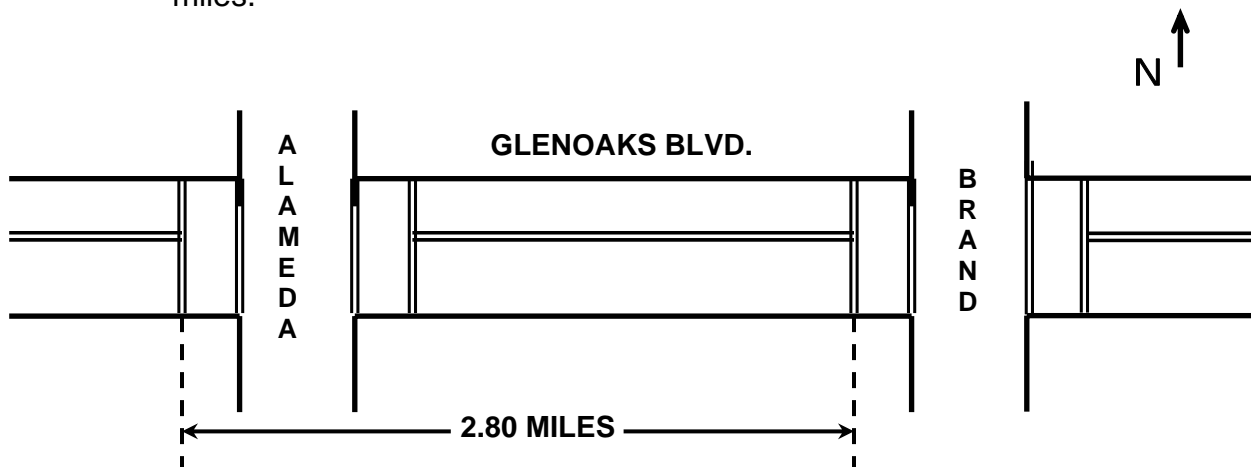

## **SCORING, PENALTIES, AND PROTESTS**

Penalties will be assessed as follows:

- ONE (1) point for each minute early and ONE (1) point for each minute late at each Time Control(TC) unless otherwise specified in the road book.
- 60 points for missing a time control
- 60 points for arriving at any Time Control later than 30 minutes from each participant's pre calculated time of arrival.
- 15 points for stopping, creeping, or evasive action within sight of a Time Control.
- Any questions about route instructions, recorded times or the road book in general should be brought up to the rally committee's attention before the final results are published

**SAFETY IS #1**